



# LESMILLS SMARTBAR

STORAGE RACK

ASSEMBLY INSTRUCTION MANUAL



The latest SMARTBAR™ is the industry's benchmark for effectiveness in fitness. At the cutting edge of innovation and design, SMARTBAR is engineered for workouts that work and solves problems that traditional barbells never knew they had. Enhancing form, results and enjoyment for your members, SMARTBAR is the ultimate in fitness equipment.

RACK ASSEMBLY	3
ACCESSORY: LOCKING UNIT ASSEMBLY	8
LES MILLS SMARTBAR RACK: SIZE AND CAPACITY	10
ACCESSORY: END CAP STICKERS	11

**PARTS LIST**

ITEM	PART	QUANTITY
1	Spine Tube	1
2	Rear Base Tube	1
3	Front Base Tube	1
4	Hanger Tube (Centre)	4
5	Hanger Tube (Left)	3
6	Hanger Tube (Right)	3
7	Bar Hanger Tube (Left)	1
8	Bar Hanger Tube (Right)	1
9	Carriage Bolt (M8/115mm)	2
10	Carriage Bolt (M8/62mm)	38
11	Washer (M8/19mm/1.5mm)	26
12	Curve Washer (M8/19mm/1.5mm)	34
13	Nylon Nut (M8/8mm)	40

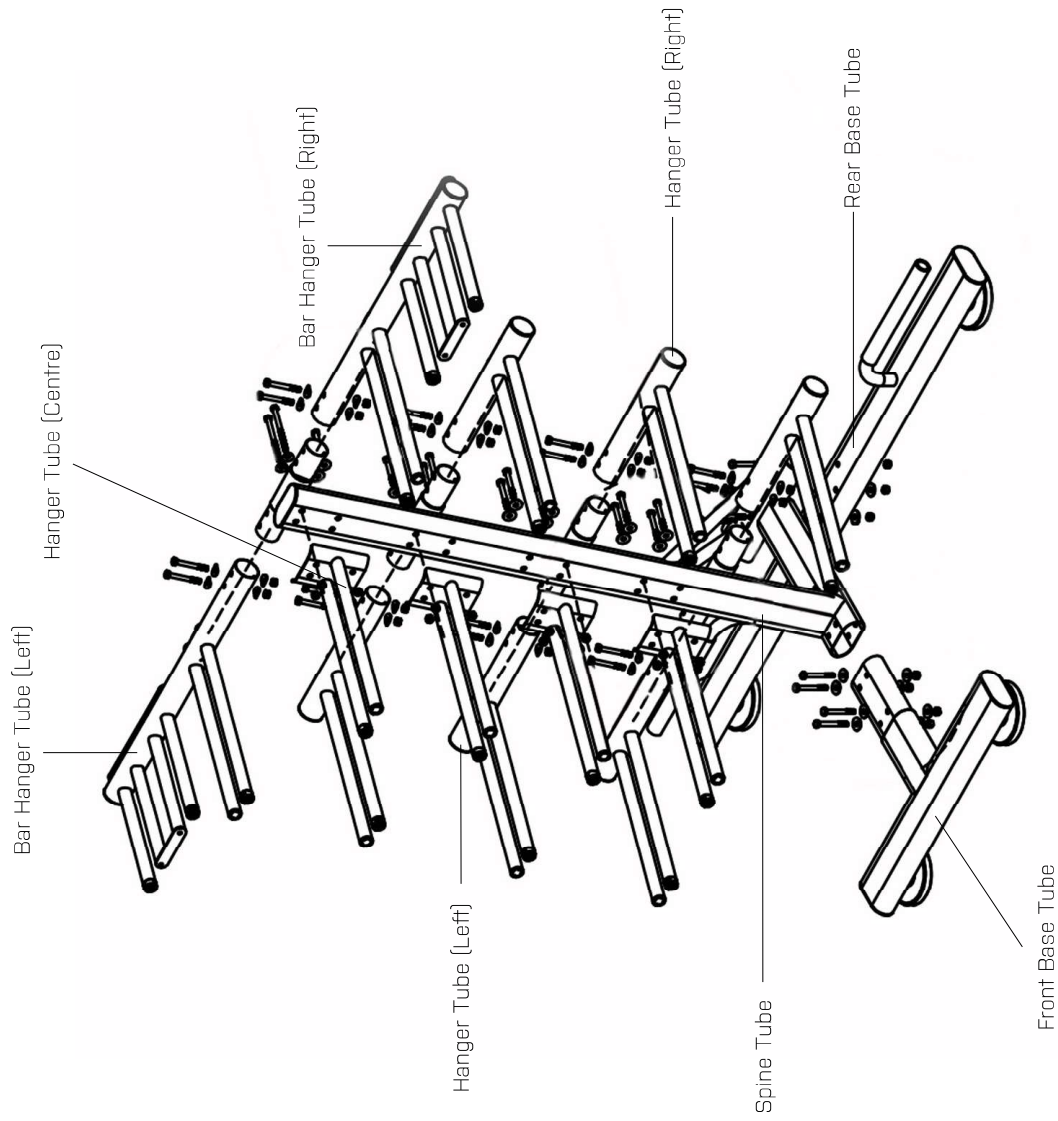

## INSTRUCTIONS

1. Remove all components from the packaging and check against the parts list on previous page.

You will need a 5mm Allen key and a 13mm spanner. It's important not to tighten the fixings fully until assembly is complete.

2. Attach Rear Base Tube (2) to the Spine Tube (1), and fasten with x4 Carriage Bolts (10), x4 washer (11) and x4 Nylon Nut (13).

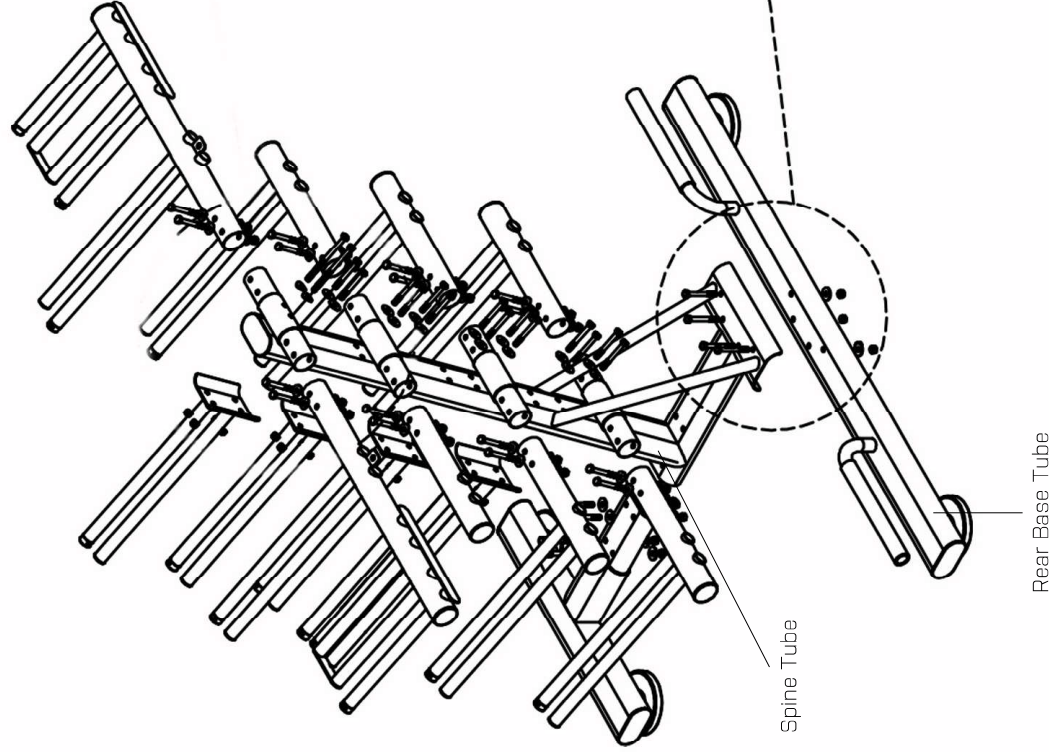

## INSTRUCTIONS

3. Attach Front Base Tube (3) to the Spine Tube (1), and fasten with x4 Carriage Bolts (10), x8 washer (11) and x4 Nylon Nut (13).

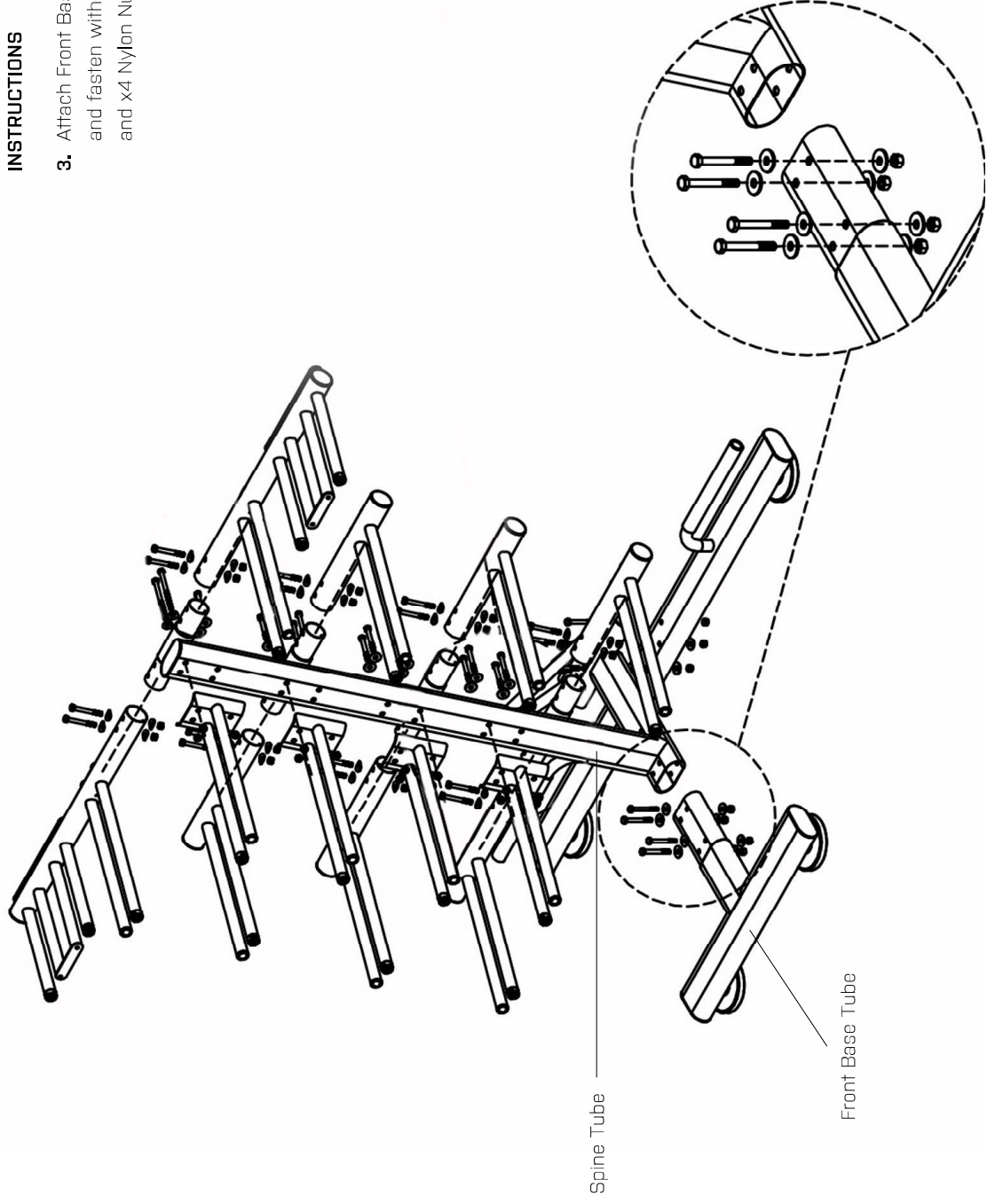

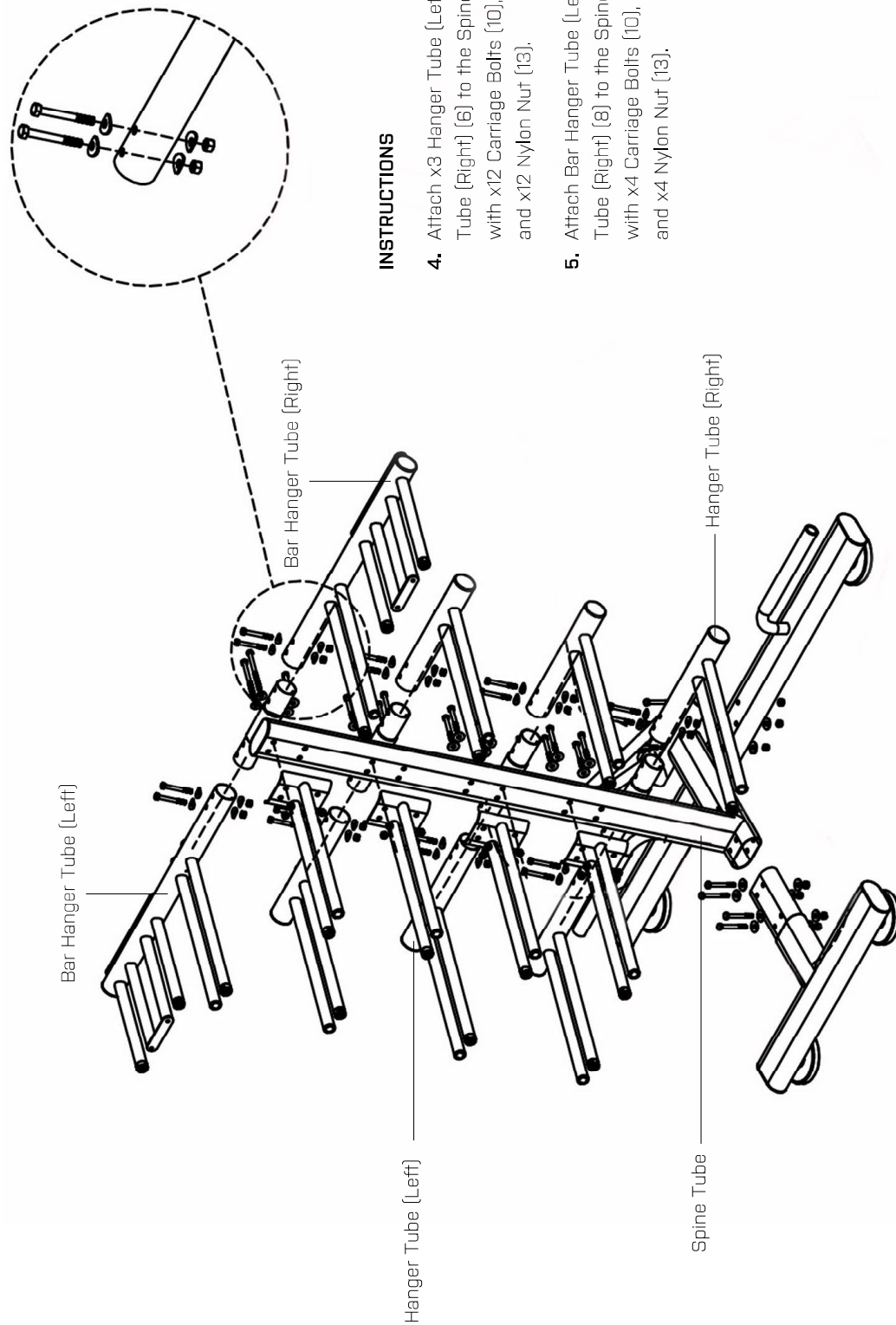

#### INSTRUCTIONS

4. Attach x3 Hanger Tube (Left) (5) and x3 Hanger Tube (Right) (6) to the Spine Tube (1), and fasten with x12 Carriage Bolts (10), x24 Curve Washer (12) and x12 Nylon Nut (13).
5. Attach Bar Hanger Tube (Left) (7) and Bar Hanger Tube (Right) (8) to the Spine Tube (1), and fasten with x4 Carriage Bolts (10), x8 Curve Washer (12) and x4 Nylon Nut (13).



## INSTRUCTIONS

6. Attach x4 Hanger Tube [Centre] (4) to the Spine Tube (1), and fasten with x2 Carriage Bolt (9), x14 Carriage Bolt (10), x2 Curve Washer (12), x14 Washer (11) and x16 Nylon Bolt (13).
7. Once all of the fixings are fully tightened the rack can be placed in position and is ready for use.

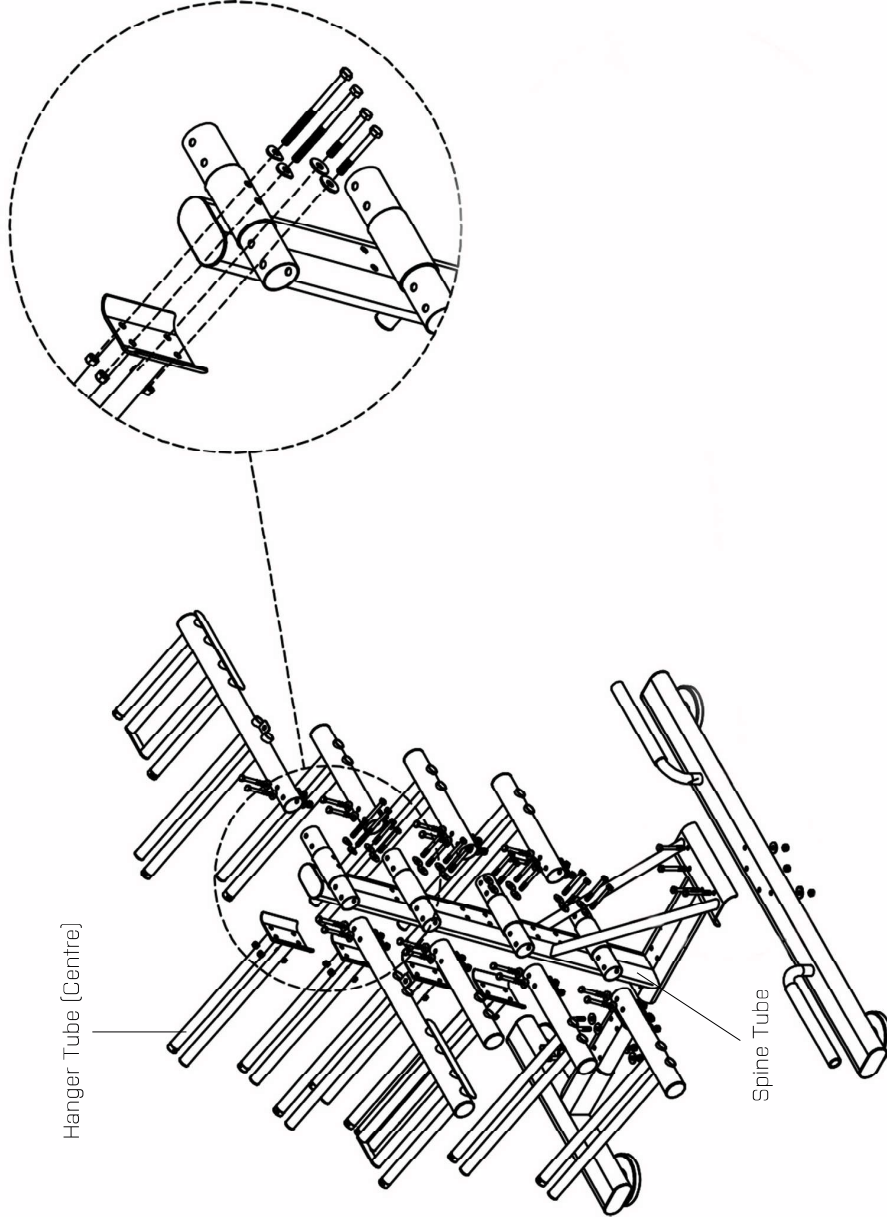



## LESMILLS SMARTBAR STORAGE RACK

### ACCESSORY: LOCKING UNIT ASSEMBLY

Lock not included.  
To be supplied by purchaser.



## INSTRUCTIONS

Feed each of the cables through Hanger Tubes as shown in the diagram. Ensure that the eyelet is at the bottom of the rack, and the stopper at the top. Attach a padlock (not included) to secure the weights to the rack. Locking unit can be stored behind the rack when not in use.

